

PARTIAL SECTION

SCALE AS NOTED

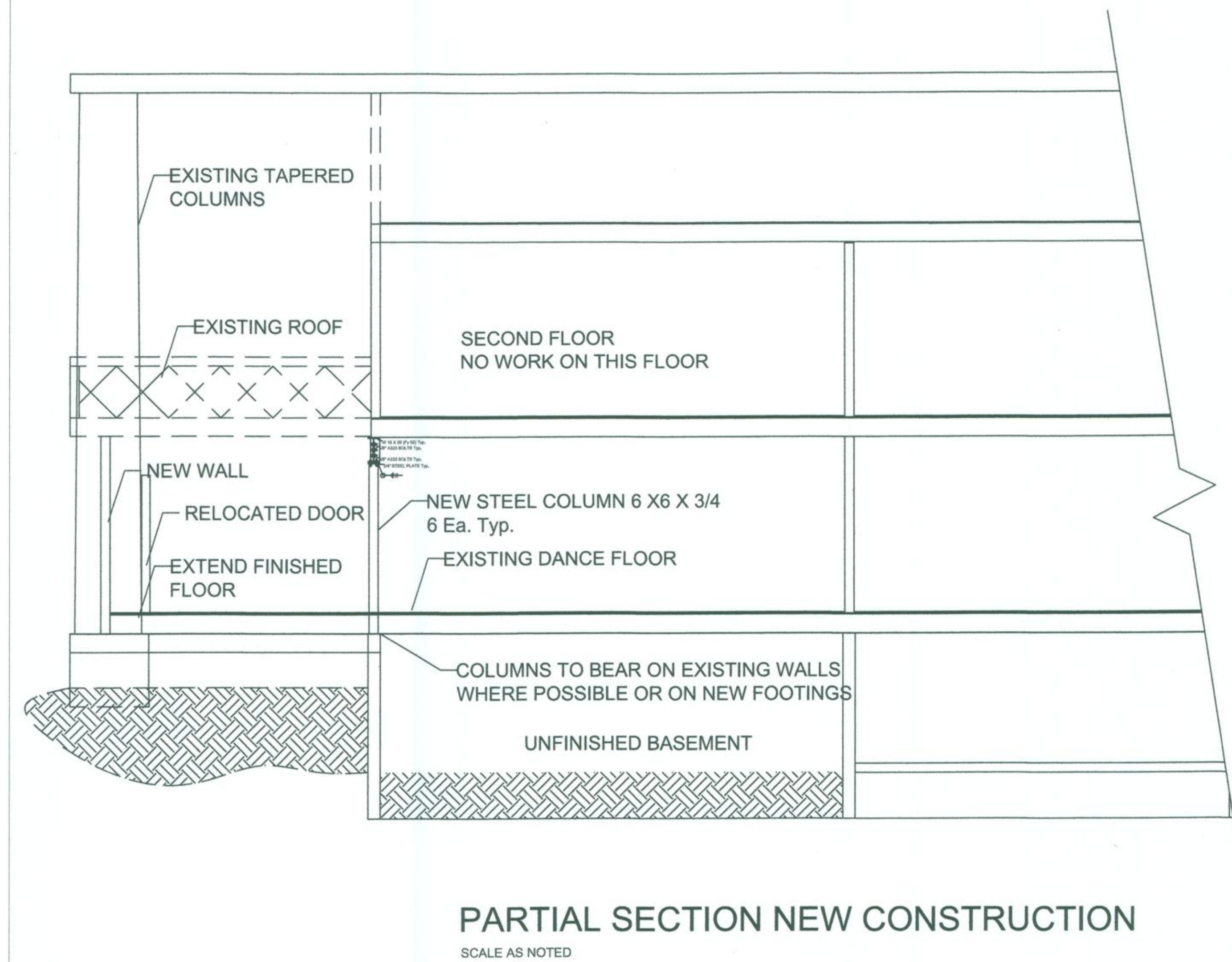

PARTIAL SECTION NEW CONSTRUCTION

SCALE AS NOTED

NOTES:

1. THE EXISTING BUILDING IS A CENTURY OLD AND HAS BEEN RENOVATED OVER THE YEARS SEVERAL TIMES THEREFORE THERE ARE NO EXISTING ACCURATE DRAWINGS OF THE PROPERTY.
2. ALL MEASUREMENTS AND INFORMATION PROVIDED ARE BASED ON FIELD MEASUREMENTS AND ON SITE OBSERVATIONS.
3. THIS PROJECT WILL BE CLOSELY OBSERVED BY BOTH THE ARCHITECT AND STRUCTURAL ENGINEER TO ADDRESS ANY FIELD CHANGES THAT HAVE TO BE MADE AND INSPECT THE PROJECT AS THE WORK IS BEING EXECUTED.
4. THERE WILL BE AN ELECTRICAL CONTRACTOR, MECHANICAL CONTRACTOR ON FILE AS WELL AS A PLUMBING CONTRACTOR, THEY WILL BE CALLED UPON TO BOTH DE-ENERGIZE EXISTING MEP INSTALLATIONS AS WELL AS THE INSTALLATION OF NEW WORK.
5. SINCE THIS IS A PARTIAL RENOVATION, SECTIONS OF THE BUILDING WILL BE CORDONED OFF ALLOWING FOR PARTS OF THE BUSINESS TO REMAIN OPERATIONAL WHILE THE WORK IS EXECUTED.
6. A GENERAL CONTRACTOR WILL BE CHOSEN AND WILL FILE ALL NECESSARY INSURANCE, COMPENSATION AND DISABILITY. THE GENERAL CONTRACTOR WILL WORK DIRECTLY UNDER THE SUPERVISION OF A CONSTRUCTION MANAGER WHO WILL ALSO SCHEDULE INSPECTIONS AS REQUIRED UNDER THE PERMIT



CONSTRUCTION
CONSULTING
CORPORATION

FORMER LaFETE MASIONS
BRIARCLIFF MANOR, NY
PRELIMINARY STRUCTURE PLAN

AOK ENGINEERING

23 AUSTIN STREET
GOUVERNEUR, NY 13642
(315) 323-4966



DRAWN BY: P.J.W.

DATE: 10.07.2017

SCALE: AS NOTED

ENG - 1005.1