

IT IS A VIOLATION OF THE LAW FOR ANY PERSON UNLESS ACTING UNDER THE DIRECTION OF A LICENSED ARCHITECT, TO ALTER THIS DOCUMENT IN ANY WAY. IF THIS DOCUMENT BEARING THE SEAL OF AN ARCHITECT IS ALTERED, THE ALTERING ARCHITECT SHALL AFFIX HIS/HER SEAL AND THE NOTATION "ALTERED BY", FOLLOWED BY HIS/HER SIGNATURE AND THE DATE OF SUCH ALTERATION, AND A SPECIFIC DESCRIPTION OF THE ALTERATION.

39 OLD ALBANY POST ROAD
OSSINING, NY

[illegible]

DATE:	NOV. 5, 2019
PROJECT NO.	110519
SCALE:	1 / 4" = 1' - 0"
DRAWING NO.	

A-12.0

framing details

4' x 8' PLYWOOD PANEL CORNER BRACE
IN LIEU OF STRAP CORNER BRACES

NAILS 12" O.C. @ 6" AT
EDGES

2" x 6" STUDS @
16" O.C.

2" x 6" DOUBLE
TOP PLATE

2" x 6" WALL
STUDS

JOIST

2" x 6" Top
Plate

(2) 104
TYPICAL

WALL SHEATHING
AND SIDING

2" x 6" SOLE PLATE

SILL PLATE

DOUBLE OR TRIPLE
END JOISTS

104 STAGGERED 12" VERT.

Foundation Walls

5/8" ANCHOR BOLTS

8d TOENAIL (TYP)

104 TOP & BOTTOM OF WOOD BRACE

CROSS BRIDGING
WOOD OR STEEL

CORNER BRACE 1" x 4" MIN. OR 1 1/4"
WOOD GAL. STEEL STRAP BRACE @ 45°;
ALSO PLYWOOD
PANEL OPTIONAL - MUST NAIL TO SILL
PLATE

BLOCKING REQUIRED
FOR SHEATHING AND
SIDING

WINDOW NOTES:

- 1) WOOD WINDOWS WITH CLAD EXTERIOR
- 2) INTERIOR WINDOW MATERIALS: PAINTED WITH FACTORY FINISH, VERIFY WITH OWNER
- 3) WINDOW HARDWARE TO BE OWNER SELECTED AT THE TIME OF ORDER.
- 4) WINDOW ROUGH OPENING: $\frac{1}{2}$ " FOR TOP/ BOTTOM & $\frac{1}{4}$ " FOR SIDES, (W/ W/ MFG.)
- 5) REFERENCE FLOOR PLANS FOR HEADER SIZES.
- 6) BEDROOM WINDOWS SILL FINISHED MUST BE WITHIN 4" OF THE FLOOR AND PROVIDE MINIMUM CLEAR OPENING OF 5.7 SQ. FEET WITH LIGHT DIMENSION NOT LESS THAN 24" AND WIDTH DIMENSION NOT LESS THAN 40" R320-R310-1.4.

1. ALL DOORS TO BE 80" HIGH
2. ALL DOOR SHALL BE SOLID CORE 1 1/2" THICK.
3. INTERIOR DOOR SHALL BE PAINTED, VERIFY WITH OWNER.
4. EXTERIOR EXIT DOORS SHALL BE 36" MIN. NET CLEAR OPENING SHALL BE 32" MIN.
5. GLAZING WITHIN 24" OF THE FLOOR AND/OR WITHIN 24" OF ANY DOOR (REGARDLESS OF WALL PLANE) ARE TO HAVE SAFETY GLAZING.
6. ALL TUB AND SHOWER ENCLOSURES TO BE GLAZED WITH SAFETY GLASS.

1. ALL TRUSSES SHALL BE INSTALLED AND BRACED TO MANUFACTURERS DRAWINGS AND SPECIFICATIONS.
2. ALL TRUSSES TO CARRY MANUFACTURERS STAMP.
3. TRUSS SHALL NOT BE ALTERED WITHIN PRIOR ENGINEERING APPROVAL.
4. ALL TRUSSES SHALL HAVE DESIGN DETAILS & DRAWINGS ON SITE FOR FRAMING INSTRUCTIONS.
5. ALL CONNECTIONS OF RAFTERS, JACK OR HIP TRUSSES TO BE PROVIDED BY TRUSS MANUFACTURER.
6. ALL ROOF TRUSSES 24" O.C., CONVENTIONAL FRAMED ROOF AREAS 16' O.C.
7. ALL ROOF OVERHANGS 18"
8. INSTALL ICE SHED AS REQUIRED
9. INSTALL POLYISOCYANURATE FOAM TYPE INSULATION AT FLOOR AND PLATE LINES, OPENINGS IN PLATES, CORNER STUD CAVITIES, AND AROUND DOOR AND WINDOW ROUGH OPENINGS.
10. GROUND SNOW LOAD 50 LBS.
11. ROOF CEILING: 1/2" OSB W/8d @ 6" OC ALL SUPPORTED PANEL EDGES, 12" OC FIELD
12. ROOF TRUSS MANUFACTURER

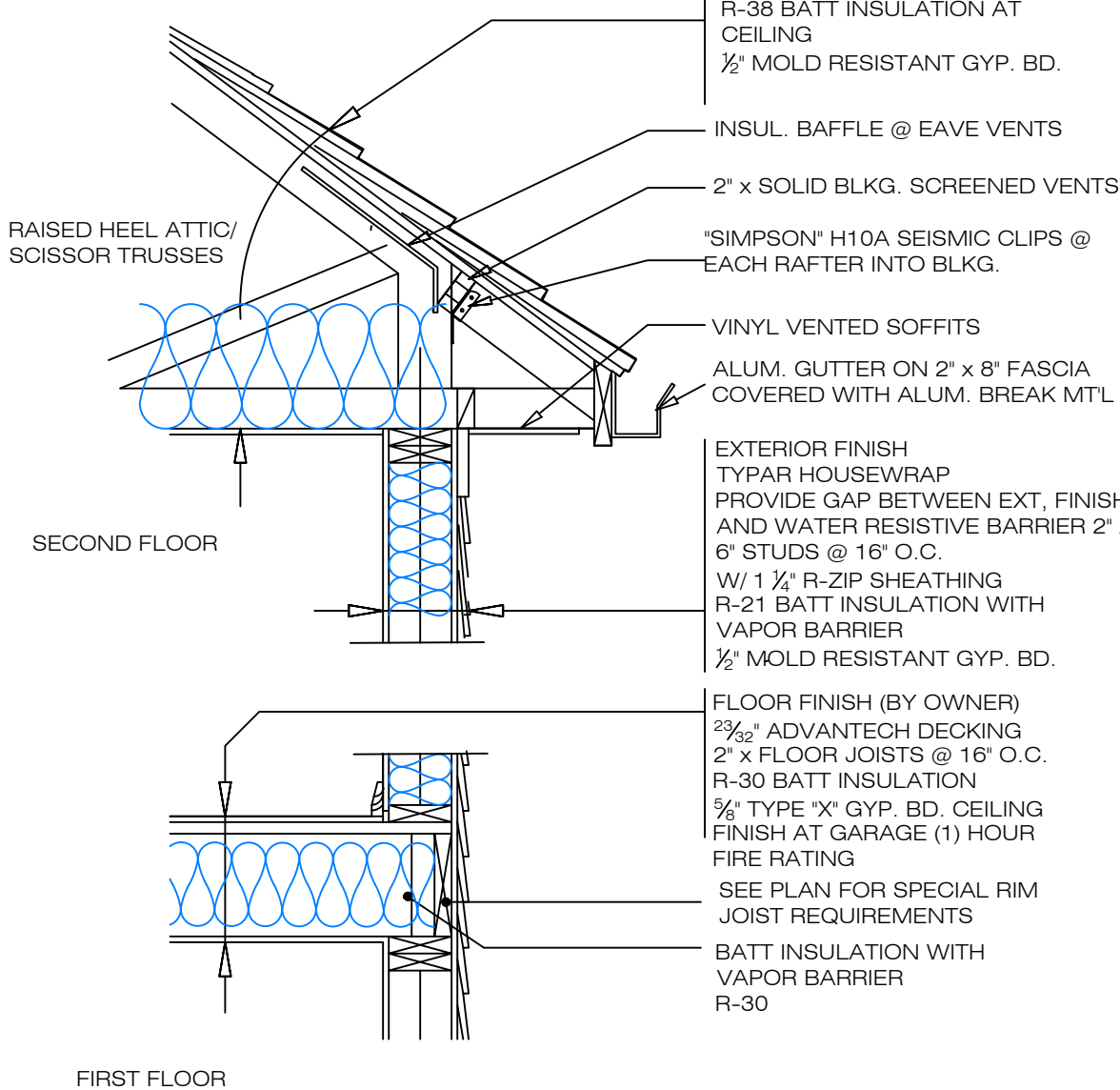

STEP 1

A. INSTALL DUPONT™ RESIDENTIAL SEALANT OR RECOMMENDED SEALANT AND BACKER JOBS NECESSARY AROUND THE WINDOW OPENING AT THE INTERIOR. IT IS ALSO ACCEPTABLE TO USE DUPONT™ WINDOW AND DOOR FOAM OR RECOMMENDED FOAM AT THE INTERIOR CAVITY OF THE JAMBS AND HEAD. IF FOAM IS USED AT THE SILL, RECOMMENDED SEALANT SHOULD BE USED AT THE SILL AREA BEHIND THE FOAM TO ENSURE A PROPER WATER BARRIER.

STEP 2

A. CUT A PIECE OF DUPONT™ STRAIGHTFLASH™, DUPONT™ FLASHING TAPE FOR HEAD FLASHING, HEAD FLASHING TO EXTEND BEYOND OUTER EDGES OF JAMB FLASHING. REMOVE RELEASE PAPER AND INSTALL COMPLETELY COVERING WINDOW MOUNTING FLANGE AND ADHERING TO THE EXPOSED FLASHING.

STEP 3

A. CUT TWO PIECES OF DUPONT™ FLASHING TAPE OR DUPONT™ STRAIGHTFLASH™ FOR JAMB FLASHING EXTENDING 1" ABOVE WINDOW HEAD FLANGE AND 4" TOP BELOW BOTTOM EDGE OF SILL FLASHING.

STEP 4

A. FLIP DOWN UPPER FLAP OF DUPONT™ TYEEK™ WBS SO IT LAYS FLAT ACROSS THE HEAD FLASHING.

STEP 5

A. REMOVE NARROW PIECE OF THE RELEASE PAPER. FAN DUPONT™ FLEXIRAP™ NF AT BOTTOM CORNERS AND ADHERE ONTO EXTERIOR FACE OF WALL. COVERAGE SHOULD BE 2" TO 7" INCHES ONTO THE FACE OF THE WALL. PRESS, SILL FLASHING IN FIRM HAND PRESSURE OR ROLLER TO ENSURE FULL ADHESION ON ALL SURFACES.

STEP 6

A. APPLY (CONTINUOUSLY) DUPONT™ RESIDENTIAL SEALANT OR RECOMMENDED SEALANT ON THE HEAD AND JAMBS OF ROUGH OPENING (ON TOP OF JAMB).

STEP 7

A. INSTALL WINDOW ACCORDING TO MANUFACTURER'S INSTALLATION INSTRUCTIONS.

STEP 8

A. REMOVE RELEASE PARTS AND PRESS TIGHTLY ALONG SIDES OF WINDOW FRAME.

STEP 9

A. TRIM THE DUPONT™ TYEEK™ WBS 1/2" ABOVE THE WINDOW OPENING.

STEP 10

A. WHEN TRIMMING THE DUPONT™ TYEEK™ WBS, DO NOT CUT OR DAMAGE THE HEAD FLASHING THAT HAS BEEN INSTALLED BEHIND IT.

STEP 11

A. TAPE ALL CUTS IN DUPONT™ TYEEK™ WBS AND TAPE ACROSS HEAD OF THE WINDOW WITH DUPONT™ TYEEK™ TAPE, DUPONT™ FLASHING TAPE OR DUPONT™ STRAIGHTFLASH™.

STEP 12

A. FLIP DOWN UPPER FLAP OF DUPONT™ TYEEK™ WBS SO IT LAYS FLAT ACROSS THE HEAD FLASHING.

STEP 13

A. TRIM THE DUPONT™ TYEEK™ WBS 1/2" ABOVE THE WINDOW OPENING.

STEP 14

A. WHEN TRIMMING THE DUPONT™ TYEEK™ WBS, DO NOT CUT OR DAMAGE THE HEAD FLASHING THAT HAS BEEN INSTALLED BEHIND IT.

STEP 15

A. TRIM THE DUPONT™ TYEEK™ WBS 1/2" ABOVE THE WINDOW OPENING.

STEP 16

A. WHEN TRIMMING THE DUPONT™ TYEEK™ WBS, DO NOT CUT OR DAMAGE THE HEAD FLASHING THAT HAS BEEN INSTALLED BEHIND IT.

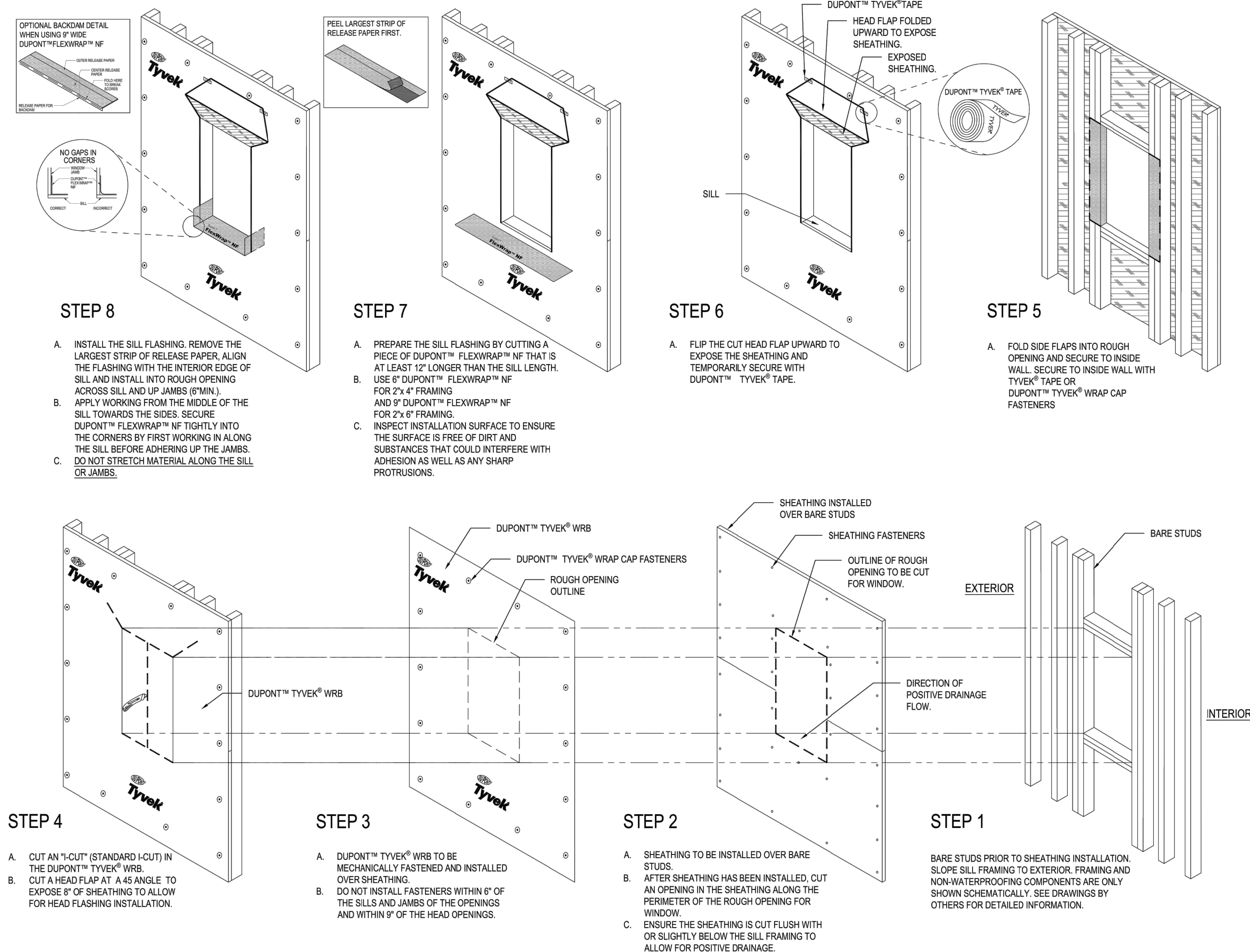

N.T.S.