

Only copies from the original of this survey marked with an original of the Land Surveyors embossed seal or red colored seal shall be considered to be true, valid copies.

Said certifications shall run only to the person for whom this survey is prepared and on his/her behalf to the title company, governmental agency and lending institutions listed hereon. Certifications are not transferable to additional institutions or subsequent owners.

Unauthorized alteration or addition to a survey map bearing a licensed Land Surveyors seal is a violation of Section 7209, Subdivision 2 of the New York State Education Law.

Possession only where indicated.

Adjacent property lines and easements not surveyed or certified. Access to adjacent rights of way, easements and public or private lands not guaranteed or certified.

Underground utilities shown hereon are approximate and should be verified before excavating. Additional underground utilities are not shown or certified. Encroachments and structures below grade, if any, not shown or certified.

Subject to covenants, easements, restrictions, conditions and agreements of record.

Premises hereon being Lot 48 as shown on a certain map entitled, "Map of Property in the Town of Ossining, known as Samstag Park." Said map filed in the Westchester County Clerk's Office, Division of Land Records October 16, 1930 as map number 3709.

Surveyed in accordance with Deed Control Number 571643415.

Premises shown hereon designated on the Town of Ossining Tax Maps as: Section 80.14, Block 2, Lot 41.

Property Address: 21 Hillcrest Avenue
Ossining, NY 10562

THIS MAP IS FOR BUILDING DEPARTMENT PURPOSES ONLY.
MAP IS NOT TO BE USED FOR TITLE TRANSFER PURPOSES.
MAP MAY NOT BE CERTIFIED TO TITLE COMPANIES AND/OR BANKS.

**SURVEY OF PROPERTY
PREPARED FOR
FANNY CARPIO AND
JUAN ILLISACA**
SITUATE IN THE
TOWN OF OSSINING
WESTCHESTER COUNTY, NEW YORK

SCALE: 1" = 10'

GRAPHIC SCALE



(IN FEET)
1 inch = 20 ft.

COPYRIGHT © 2022
TC MERRITTS LAND SURVEYORS
ALL RIGHTS RESERVED, UNAUTHORIZED DUPLICATION OR
ELECTRONIC TRANSMISSION WITHOUT PRIOR PERMISSION
IS A VIOLATION OF APPLICABLE LAWS.

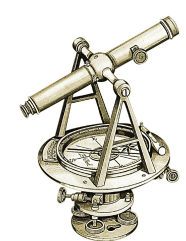

TC MERRITTS LAND SURVEYORS

394 BEDFORD ROAD • PLEASANTVILLE • NY 10570
(914) 769-8003 • survey@tcmerritts.com

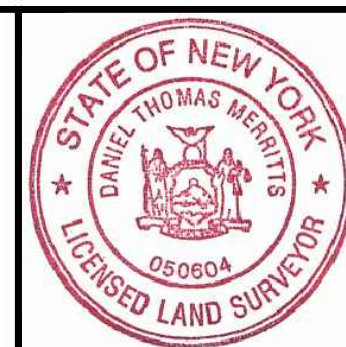

Surveyed: March 8, 2022
Map Prepared: March 15, 2022

By: *Daniel T. Merritts*
New York State Licensed Land Surveyor No. 050604

Project: 22-054	Reference: N/A
Field Survey By: CR/MM	Drawn By: BIC
Project Manager: BFC	Checked By: BFC